

# RESTLAWN GARDENS SECOND ADDITION

SEWARD COUNTY, KANSAS  
MARCH, 1999

PLAT LI

316.61' N00° 00'00"W

DRIVE

20'

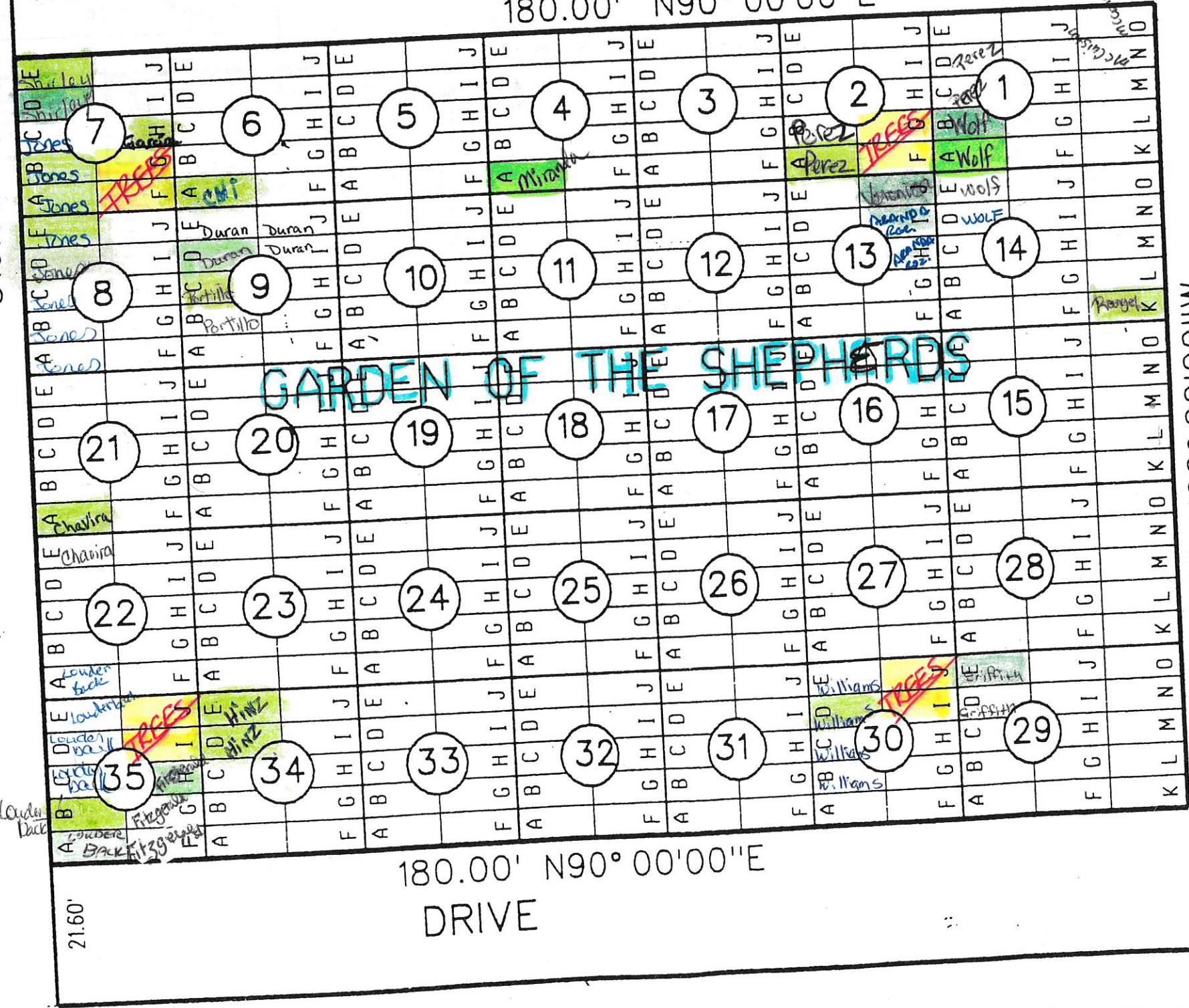

180.00' N90° 00'00"E  
DRIVE  
180.00' N90° 00'00"E

125.00' N100° 00'00"W

20'